



# multiclip® e multifix™

MULTICLIP® e MULTIFIX are patented systems easy to mount and to dismount without damaging the work done.

### MULTICLIP® assembly:

1. Set the base profile in position using either screws and dowels or the perforated fixing base flange for adhesive laying.
2. Align the base section to the wooden floor edge to allow to suitable gap for expansion joints.
3. Insert one or more "clips" into the finishing profile and align onto the fixing base.
4. Protecting the finishing profile with a wooden batten tap the clips into the fixing base.

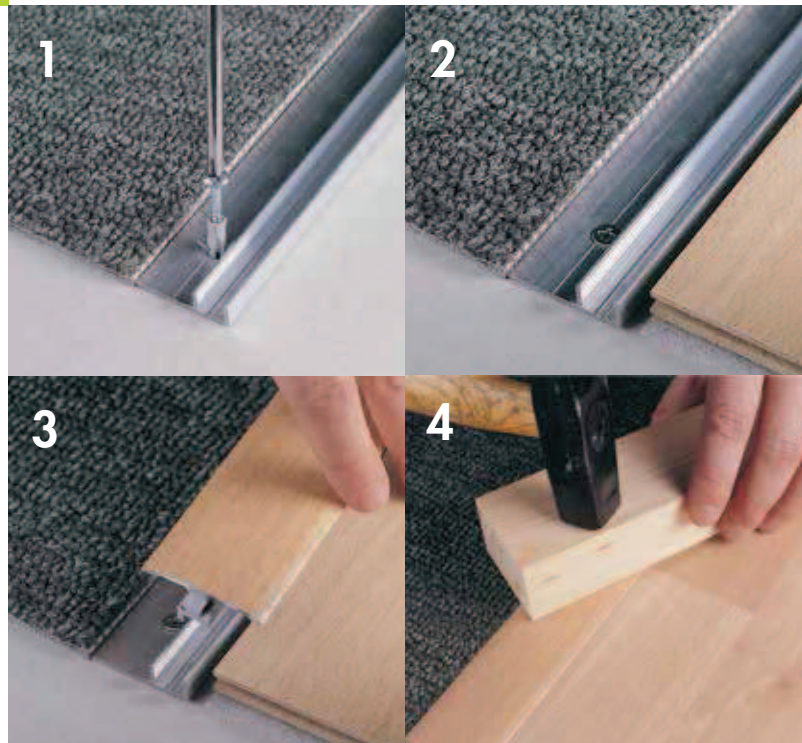

### MULTICLIP® disassembly

Where necessary, the profile can be easily removed without damaging the laid floor or the fixing base.

1. Drill hole with a 3 mm drill bit
2. Insert a 4 mm screw
3. Lift and remove



### MULTIFIX assembly

The profile series MULTICLIP® may be assembled and laid by use of the nylon dowel "MULTIFIX" whenever there is a limited or residential type of pedestrian transit. The MULTIFIX dowel is utilized with these articles: CLG 300, CLG 370, CLF 450.

1. Drill hole using a 6 mm drill bit
2. Insert the dowels
3. Align the dowels
4. Hammer in with protecting batten

