

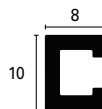

LISTEC LI 10 decorative strips in aluminium for ceramic tiling. The particular squared cross section integrates perfectly with the new ground sizes in porcelain stoneware and the fixed depth of 8 mm makes it versatile and adaptable to any tile thickness over 7 mm thanks also to the special compensating shims (see page 126).

listec LI 10



LISTEC LI 10:

1. Enhances the bath finish by decorating the tiles with a modern, minimalist design.
2. Eliminates the need for special pieces, adapting to every type of finish and size of tile.
3. The shim LIA makes it suitable for tiles from 10 to 12 mm.

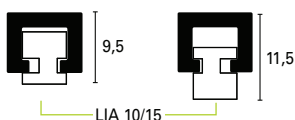
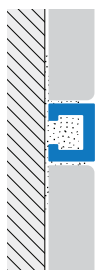

LISTEC LI 10-A* Anodised Aluminium

Aluminium Listello available in Silver anodised (AS), Bright polished chrome (ASB) or Silver Brushed (ASS), to create decorative effects with minimal and elegant solutions.

	B=mm	Art.		
Material: Anodised Aluminium	10	LI	10	AS/ASB/ASS
Finish: Silver (AS), Polished chrome (ASB), Silver brushed (ASS)				