



RJM 44 A

Jolly profile with the new 'X' design for an improved mechanical fixing of the vitreous mosaic tesseras. The visible element is symmetrically rounded and is fit for the protection of corners and stair nosings. Designed specifically for the perfect installation of vitreous mosaic, with a thickness of approx. 4mm and a 20mm x 20mm format.

SJM 44 A

Squarejolly range specifically developed for mosaic. Multipurpose profile used either to create external corners, to finish edges or as a decorative listello. Ideal for most types of installation, the profile provides neat edge finishing with equal visible sides.

The profile is available with a universal cube-shaped end cap to be used as internal, external and three-way junction.

RJF 44 A

Functional profile for joining and finishing external corners with an extremely reduced section. An ideal solution where a trim is necessary but a minimalist look is required. The profile shape lends itself to 'countersunk' design of the edge of the tessera, therefore protecting the fragile edges of the mosaic. A simple design for maximum results.



RJF



CRM

CRM 44 A

Aluminium profile developed to provide a minimalist, hygienic join between vitreous mosaic floors and walls. Designed to be used with the other profiles of the M range, it creates a valuable decorative metal lines effect with a minimalist and smooth thickness. Ideal for joining internal corners of kitchen worktop surfaces or shower cubicles.

LIM 44 A

Innovative profile for the creation of minimalist decorative listellos. It is integrated into the natural gap between the mosaic, replacing the grout line and therefore not displacing the tesseras.

This allows the creation of unique design effects, both horizontal and vertical and single and multiple, without the need to continue the listello along the entire mosaic line. The profile is installed at the same time as the mosaics, guaranteeing a secure fit whilst ensuring that irregularities do not occur in the surface finish of the mosaics.

RJM 44 A

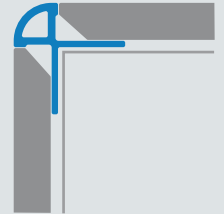

SJM 44 A

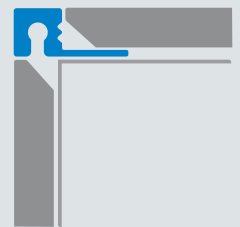

RJF 44 A

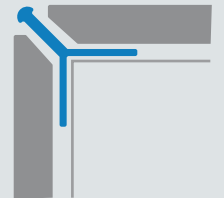

CRM 44 A

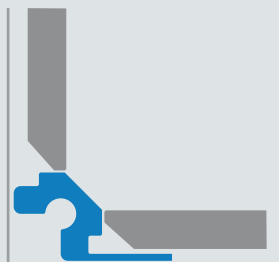

LIM 44 A

